



# Product Data Sheet

**Horizontal A.C. Motors**  
**Close Coupled Pump Unimount 125®**  
**Totally Enclosed Fan Cooled**



- **TEFC Close Coupled Pump Motor**
- **JM, JP or Westcoast Shaft**
- **1.25 Service Factor**
- **1 -30 HP, 3600 and 1800 rpm**  
**200, 208-230/460 & 575 volt**
- **Standard and premium Efficiency**
- **Single and Three Phase**
- **ALLGUARD® Motor Quality System**



**EMERSON. CONSIDER IT SOLVED.™**

©Emerson Motor Company, 2003; All Rights Reserved

## Product Overview

U.S. Motors' **Unimount 125® Close Coupled Pump** motor is a totally enclosed fan cooled motor with a 1.25 service factor. These close coupled pump motors meet standard NEMA requirements rated for 40°C ambient conditions including class F insulation (with class B temperature rise), NEMA Design B and usable up to 3,300 feet above sea level.

The Unimount has an aluminum alloy extruded frame that improves heat dissipation for cool operation and long life (180 frame and larger). Die cast aluminum brackets have steel or cast iron bearing cavity inserts to ensure reliable performance under severe load applications. The 56 and 140 frames are rolled steel. All of the close coupled pump motors are made with oversized locked ball bearing construction, and diagonally split conduit boxes which are NEMA™ standards.

All copper windings and low loss stator laminations provide maximum efficiency. The Close Coupled Pump Unimount motor is offered in both high efficient type UT and the premium efficient type UTE. This allows you to choose the level of motor efficiency that best suits the needs of your application.

The Unimount Close Coupled pump motor was designed for the specific requirements of centrifugal pumps.

- JM shaft motors (listed as CCP Type UT-4)
  - Mechanical seal held in place by springs or other constant pressure device.
  - C-faced motor with special shaft
  - Designed for pump impeller to be installed directly to shaft
- JP Shaft Motors (listed as CCP Type UT-1)
  - Originally designed for a packing type seal.
  - C-faced motor with special shaft
  - Designed for pump impeller to be installed directly to shaft

Single phase units, 3 to 10 horsepower, are also available from stock. In both JM or JP shafts, 184 thru 215 frames.

In addition to the stock product offerings listed in our catalog, we are able to extend the product range to other ratings and requirements, such as 1200 rpm. For a more comprehensive description of our close coupled pump motors including model numbers and list prices, please consult the U.S. Electrical Motors' Motor Catalog.



# Product Features

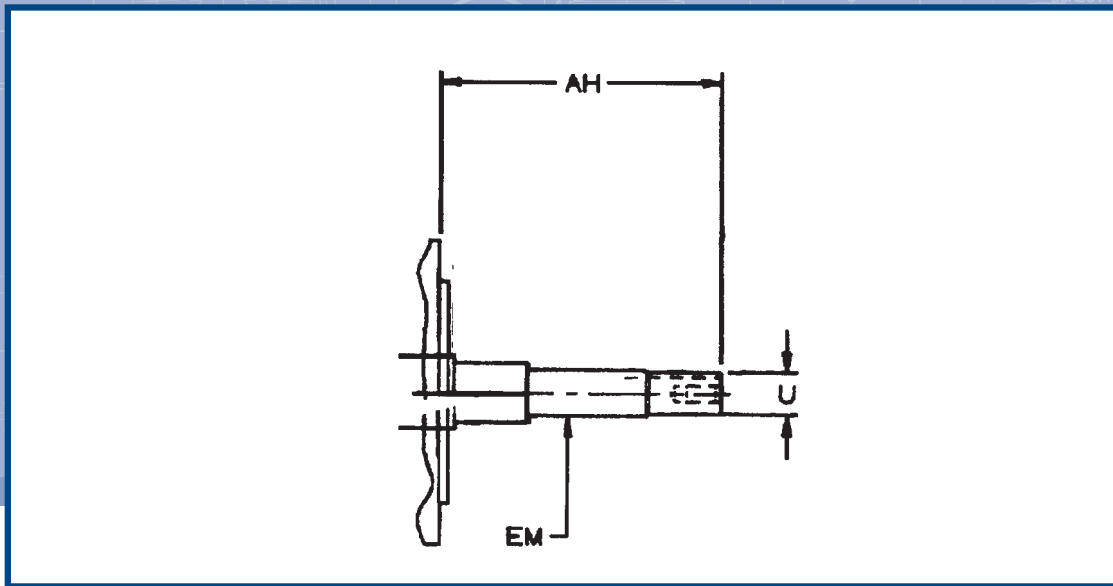

CCP TYPE	AH Shaft Length	U Shaft End	EM Shaft Width
<b>UT-1</b> 143-184JP 213-215JP 254-256JP 254-286JP	7-5/16" 8-1/8 8-1/8 8-1/8	7/8" 1-1/4 1-1/4 1-1/4	1" 1-3/8 1-3/8 1-3/8
<b>UT-4</b> 143-184JM 213-215JM 254-256JM 284-286JM	4-1/4 4-1/4 5-1/4 5-1/4	7/8 7/8 1-1/4 1-1/4	1 1 1-3/8 1-3/8
<b>UT-3</b> 213-215TCZ	7-5/16	7/8	1



## Available Stock Configuration

### **JP Shaft type UT-1**

Three Phase  
1 thru 30 HP  
143JP thru 286JP Frame  
3600 and 1800 rpm  
200, 208-230/460, 575 Volt

### **JM Shaft type UT-4**

Three Phase  
1 thru 30 HP  
143JM thru 286JM Frame  
3600 and 1800 rpm  
200, 208-230/460, 575 Volt

### **JP Shaft type UTM-1**

Single Phase  
3 thru 10 HP  
182JP thru 215JP Frame  
3600 and 1800 rpm  
115/230, 230 Volt

### **TCZ Westcoast shaft UT-3**

Three Phase  
213TCZ thru 215TCZ Frame  
7-1/2 HP thru 15 HP  
3600 and 1800 rpm  
230/460 Volt

### **JM Shaft type UTE-4**

Three Phase  
Premium Efficient  
1 thru 20 HP  
143JM thru 256JM Frame  
3600 and 1800 rpm  
230/460, 575 Volt

### **JM Shaft type UTM-4**

Single Phase  
3 thru 10 HP  
182JM thru 215JM Frame  
3600 and 1800 rpm  
115/230, 230 Volt

Emerson Motor Technologies, a global leader in the design and manufacture of electrical motors, provides a complete line of general and special purpose electric motors from 1/200 through 4,000 horsepower. Brands such as Emerson, Doerr, U.S. Electrical Motors, Hurst, and Switch Reluctance Drives, allow Emerson Motor Technologies to support a wide variety of applications including commercial and industrial, appliance, hermetic, automotive, and HVAC. For more information about Emerson Motor Technologies visit [www.emersonmotors.com](http://www.emersonmotors.com).

St. Louis-based Emerson ([www.gotoemerson.com](http://www.gotoemerson.com)) is a global leader in bringing technology and engineering together to provide innovative solutions to customers in industrial automation; process control; heating, ventilating and air conditioning; electronics and telecommunications; and appliance and tools. Sales in fiscal 2002 were \$13.8 billion.

Emerson Motor Co.  
8100 West Florissant Ave.  
St. Louis, MO 63136  
Phone: 888 637 7333  
Fax: 314 553 2087  
[www.usmotors.com](http://www.usmotors.com)  
[www.emersonmotors.com](http://www.emersonmotors.com)

